

Bluetooth 5.0 Adapter | Installation

Notes

- The product applies to Windows 7/8.1/10. Installation and pairing operations may vary from different systems.
- The demonstration in this manual takes Windows 10 computer system and HONOR phones P40 as examples.
- Except mobile phones, the product also applies to Bluetooth devices such as mice/keyboards/game controllers/speakers/headsets, etc.
- The product is unavailable to macOS/iOS devices.
- Once the product and your device are paired for the first time, they will enter au to-reconnection mode next time.

Step One—Drive Installation

1. Plug the Bluetooth adapter into USB port of the computer, the Bluetooth menu will recognize it and display as Bluetooth icon [8] on the lower right corner immediately.

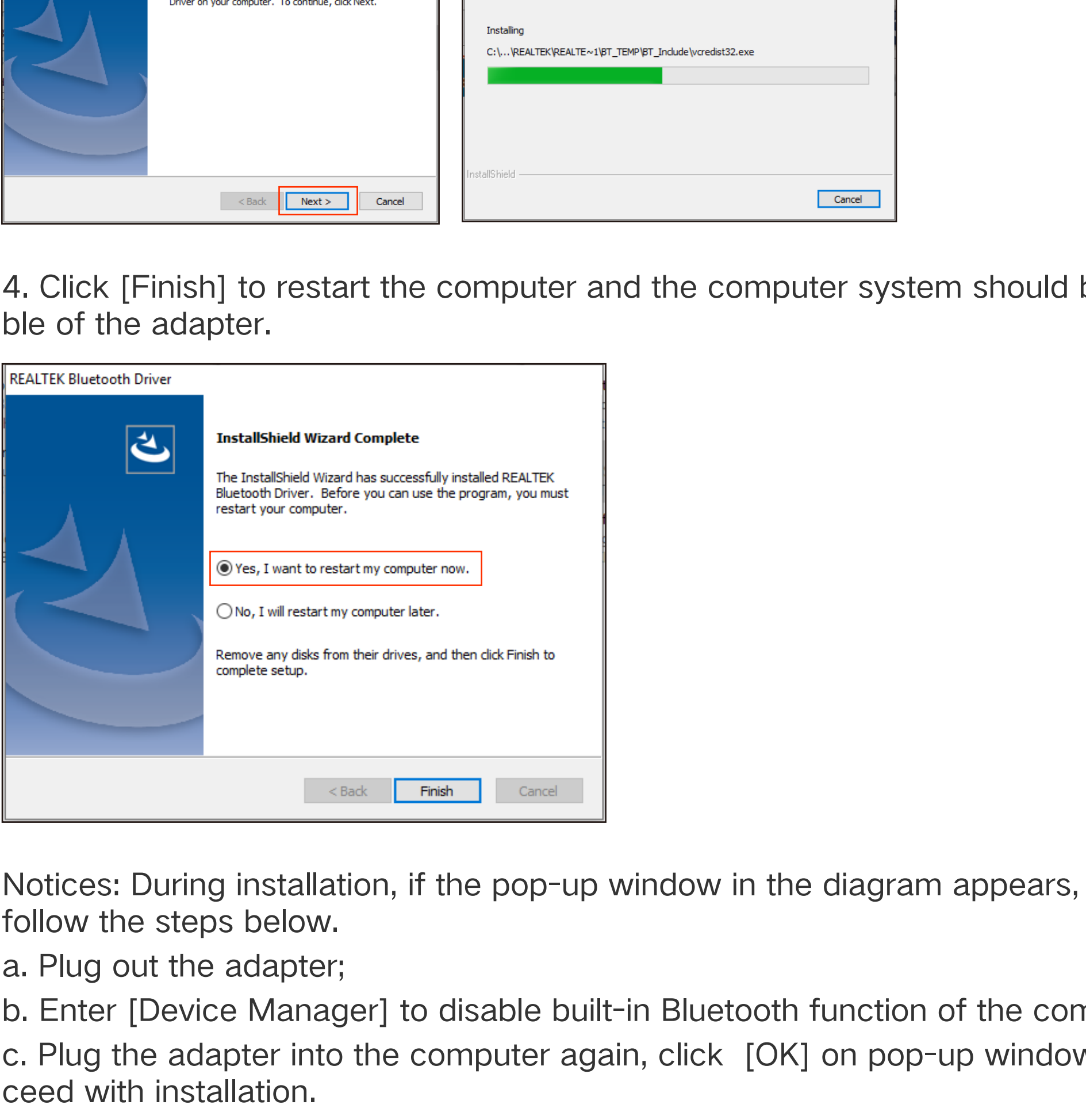

3. Follow the pop-up window to click [Next].

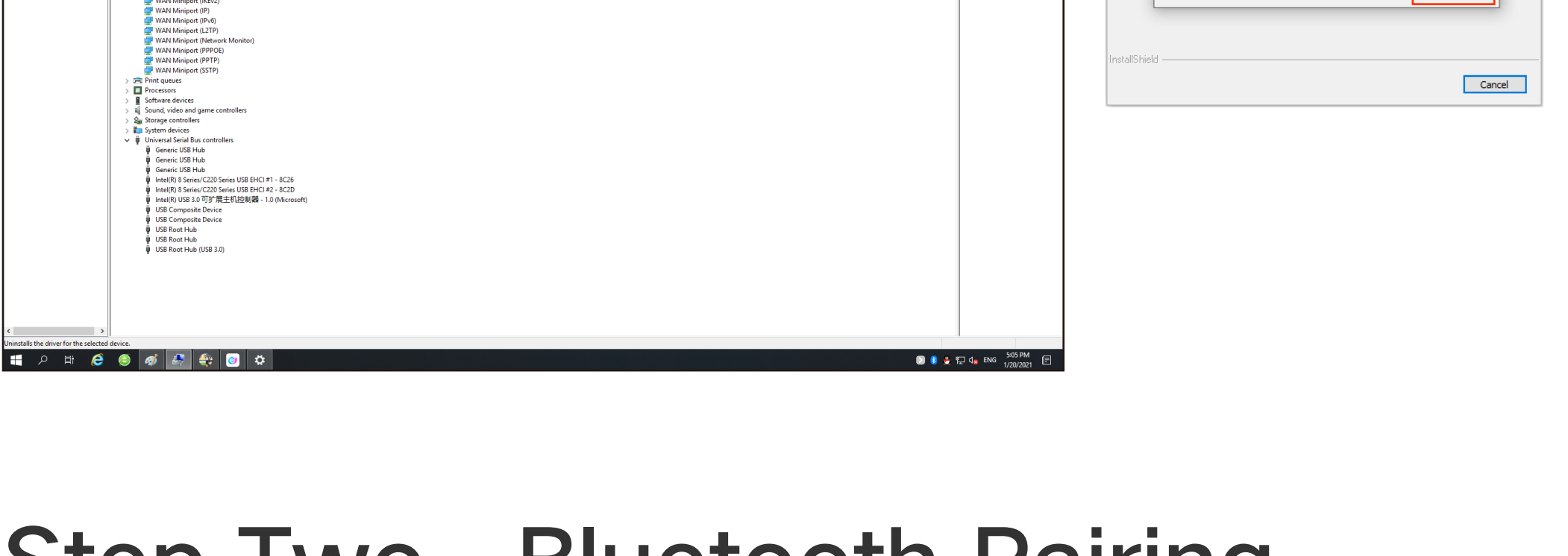

4. Click [Finish] to restart the computer and the computer system should be capable of the adapter.

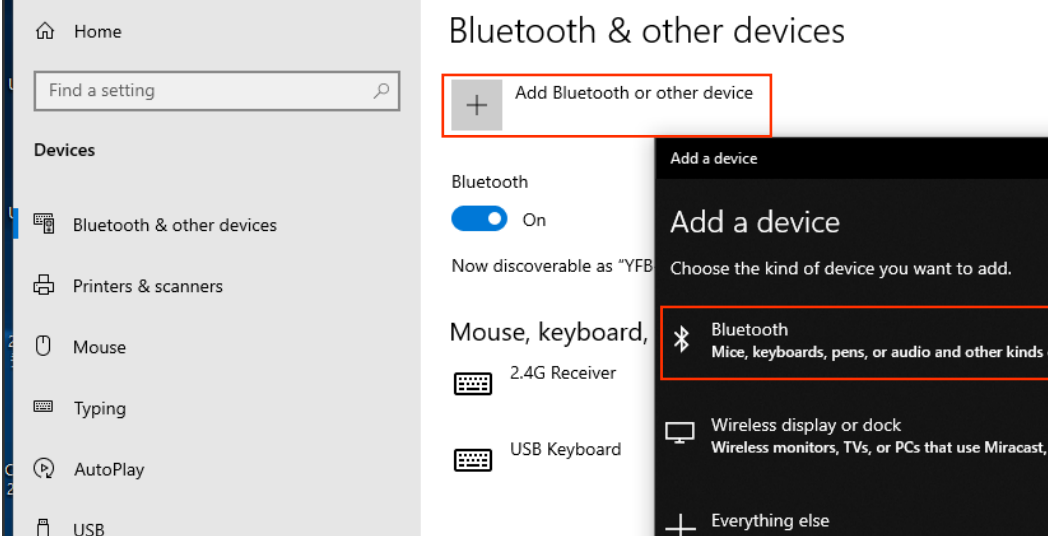

Notices: During installation, if the pop-up window in the diagram appears, please follow the steps below.

- a. Plug out the adapter;
- b. Enter [Device Manager] to disable built-in Bluetooth function of the computer.
- c. Plug the adapter into the computer again, click [OK] on pop-up window to proceed with installation.

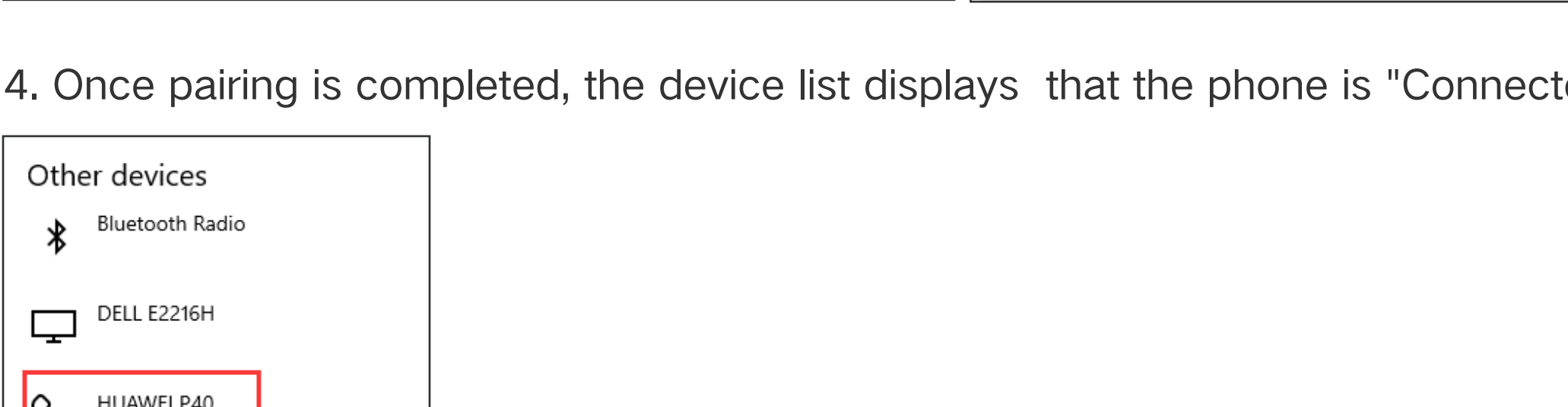
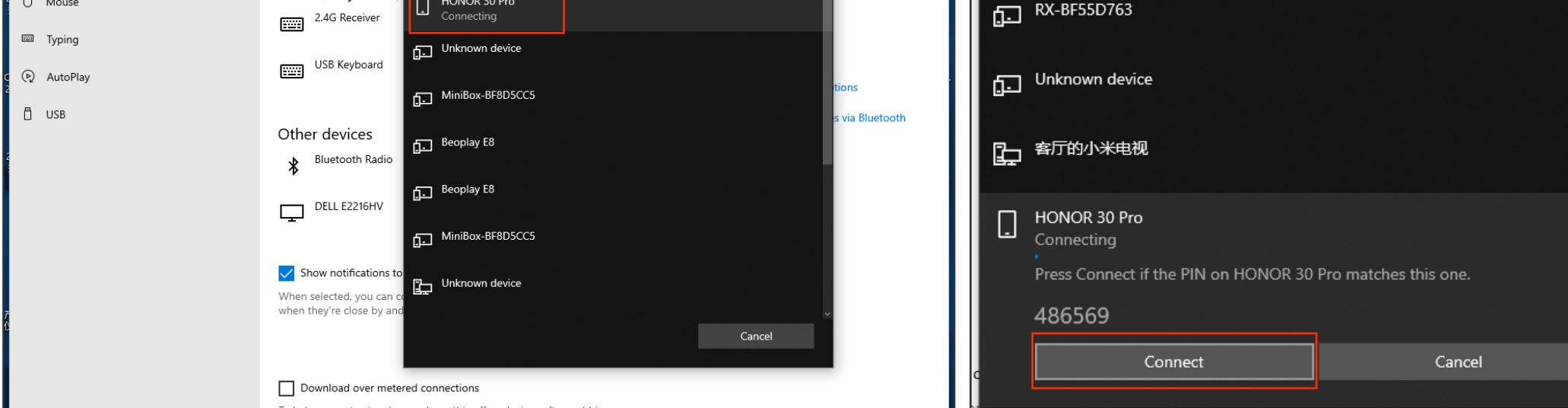

Step Two—Bluetooth Pairing

1. Turn on Bluetooth on the Phone.

2. Double-click the icon [8] on status bar of the computer, click icon [+], then click [Bluetooth] to enter the Bluetooth devices list.

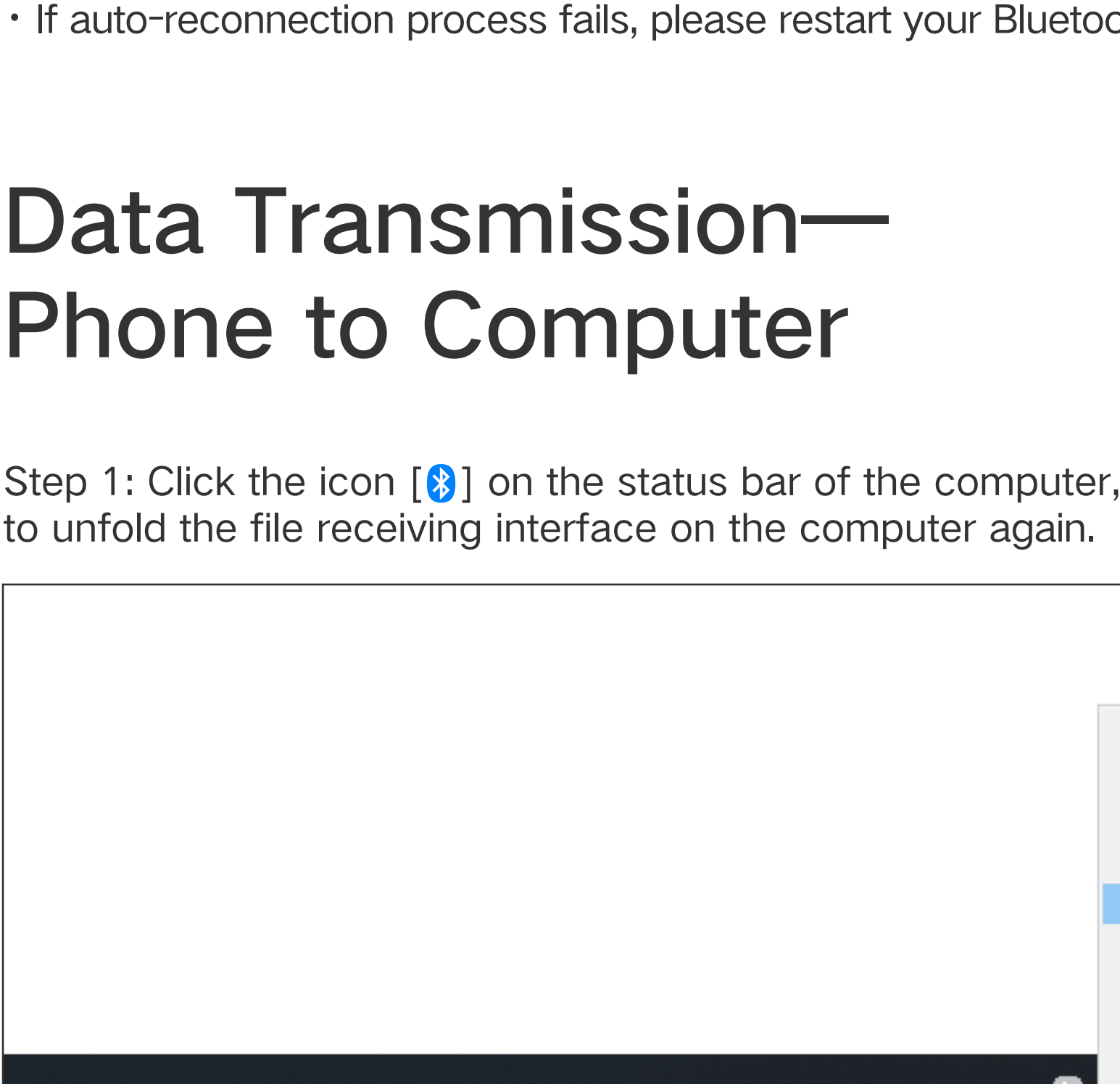

3. Locate the phone model on the list, click [Connect], the phone will pop-up "Bluetooth pairing request", click [Pair] on the phone.

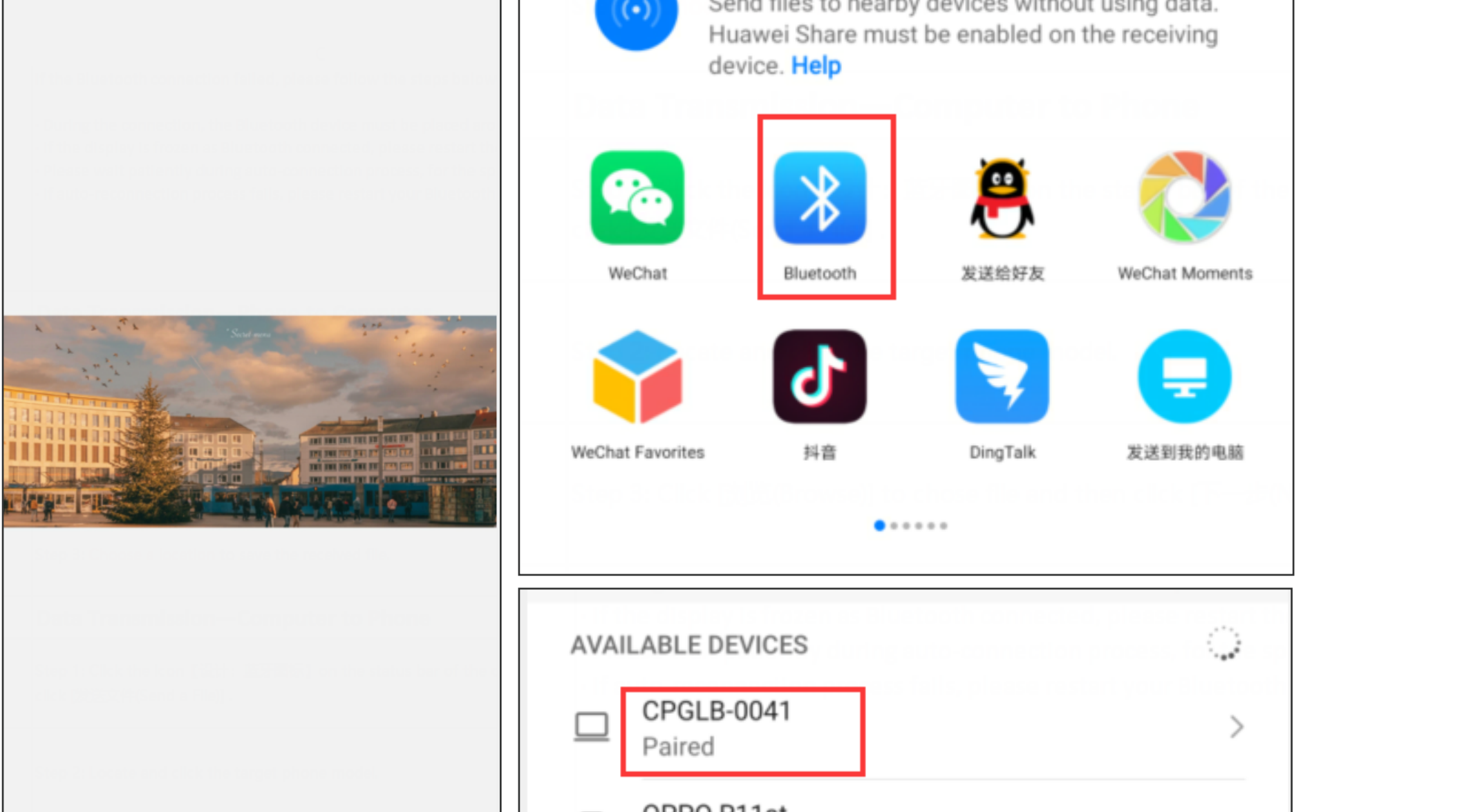

4. Once pairing is completed, the device list displays that the phone is "Connected"

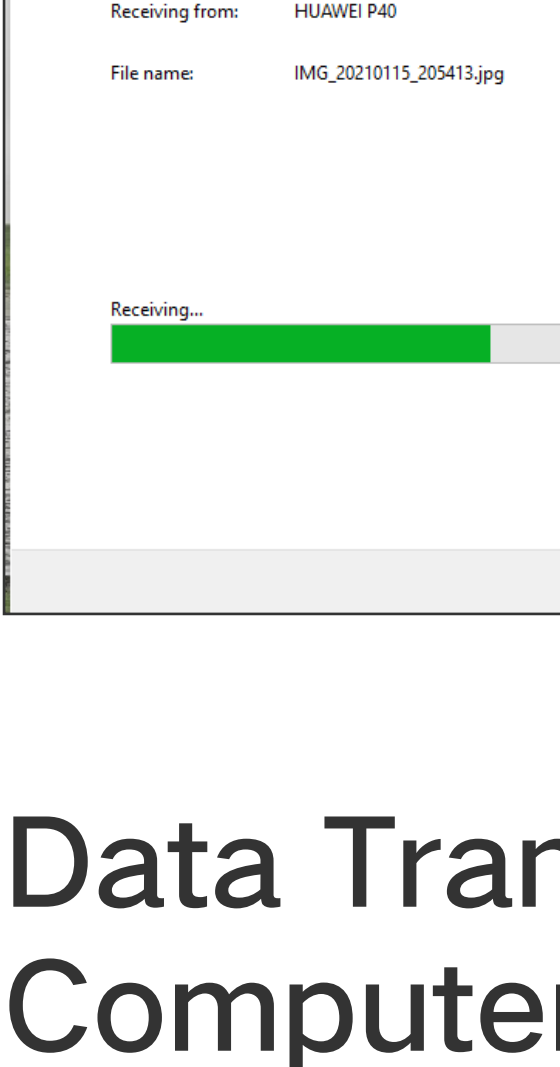

Notes:

- For other Bluetooth devices (speakers/mice/game controllers), click the device name to connect them to the computer.
- For Bluetooth keyboard, the computer will generate a PIN, enter the PIN on the keyboard to complete pairing.

FAQ

If the Bluetooth connection failed, please follow the steps below:

- During the connection, the Bluetooth device must be placed around the product at a range of 20m.
- If the display is frozen as Bluetooth connected, please restart the player.
- Please wait patiently during auto-connection process, for the speed may vary from different computer systems.
- If auto-reconnection process fails, please restart your Bluetooth device and try again.

Data Transmission—Phone to Computer

Step 1: Click the icon [8] on the status bar of the computer, click [Receive a File] to unfold the file receiving interface on the computer again.

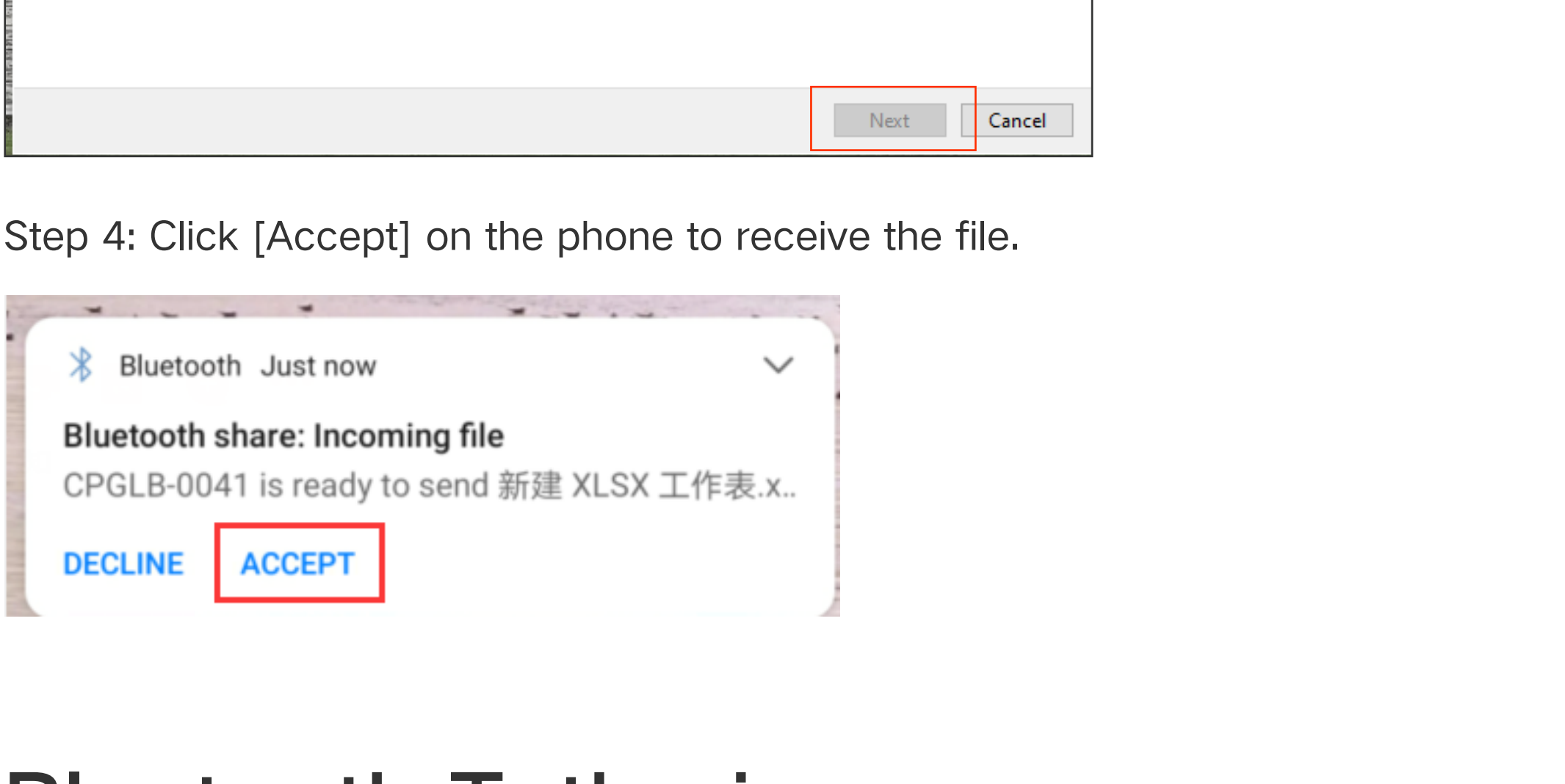

Step 2: Choose a file (video/picture/document) on the phone. Click [Share] on its status bar and click the icon [Bluetooth], click the computer's name and waiting for it finish receiving.

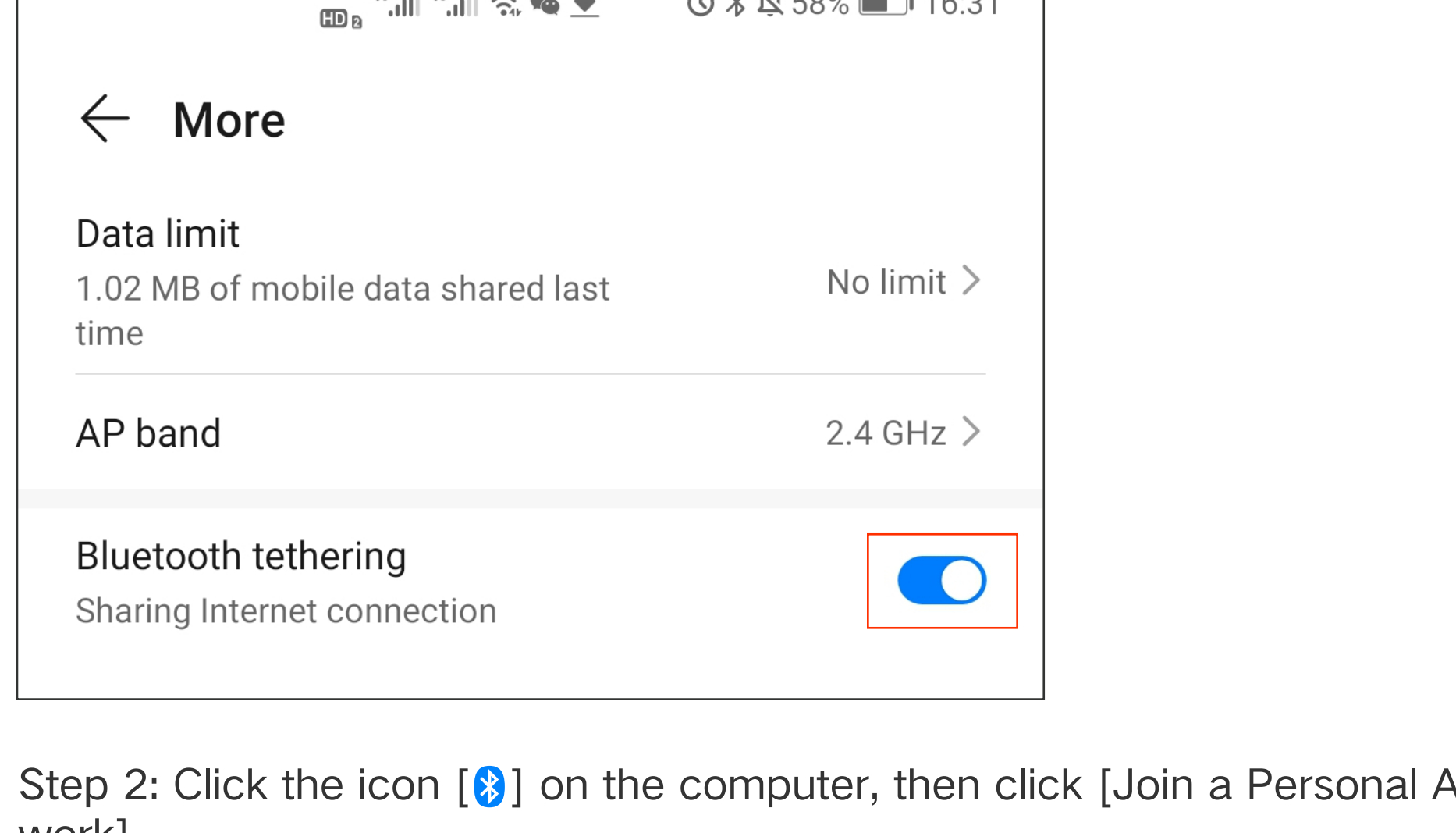

Step 3: Choose a location to save the received file.

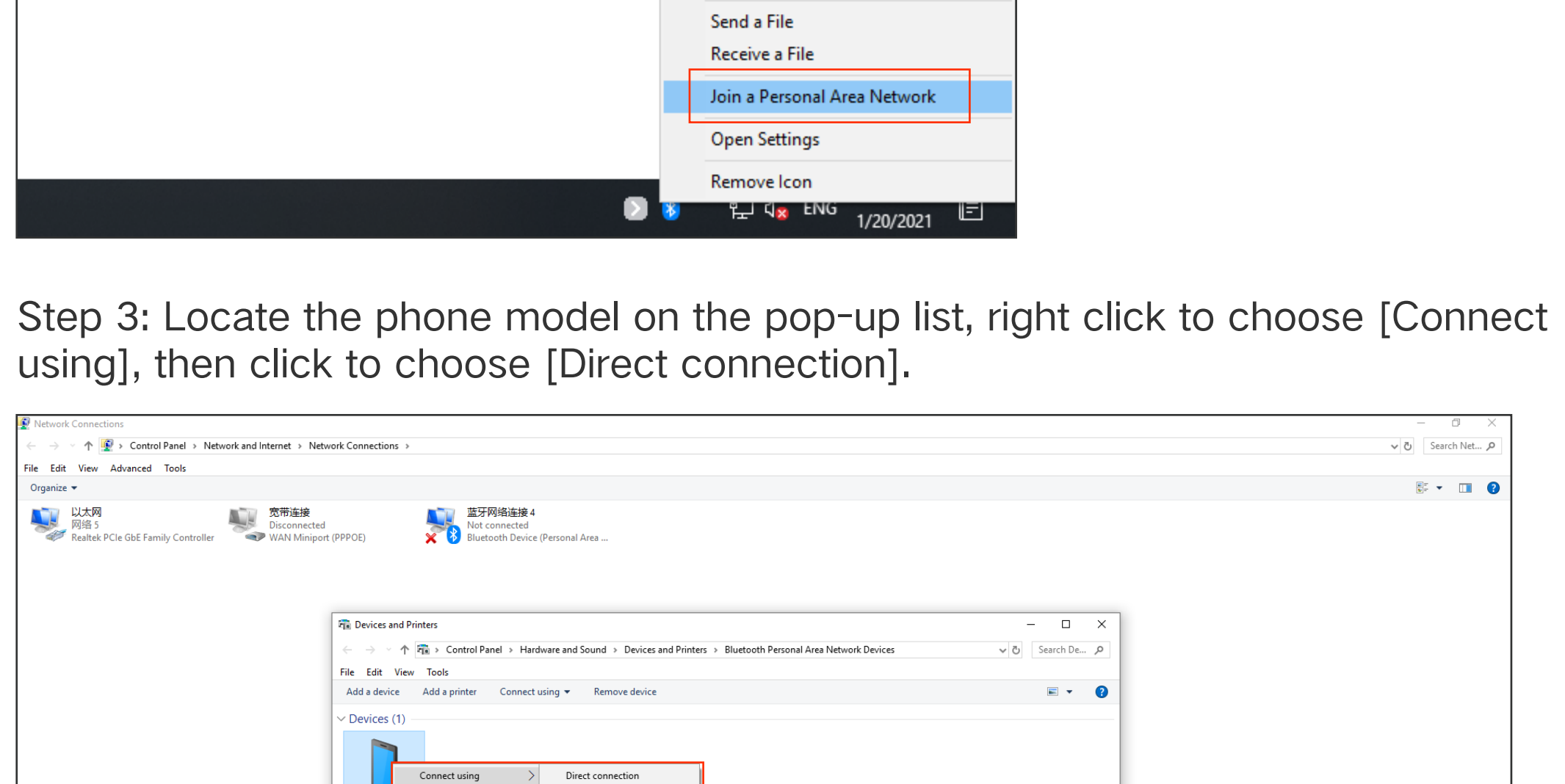

Data Transmission—Computer to Phone

Step 1: Click the icon [8] on the status bar of the computer, then click [Send a File]



Step 2: Locate and click the target phone model.

Step 3: Click [Browse] to choose file and then click [Next].

Step 4: Click [Accept] on the phone to receive the file.

Bluetooth Tethering

Step 1: Turn on Bluetooth tethering on the phone.

Note: The way to turn on Bluetooth tethering is differ from phone models, please refer to their own user manual.

Step 2: Click the icon [8] on the computer, then click [Join a Personal Area Network].

Step 3: Locate the phone model on the pop-up list, right click to choose [Connect using], then click to choose [Direct connection].

Step 4: A pop-up window shows "successful connection".

